

**LEGEND**

- EXISTING TOP OF BANK
- EXISTING TOE OF BANK
- EXISTING CONTOURS (AT 2.0m, INDEXED AT 10.0m)
- CONCRETE STORMWATER CLASS 2 TO AS 4058 SIZE TO BE DETERMINED
- KERB INLET PIT TO FNOROC STD. DWG. S1050, S1055 OR S1070 AS APPLICABLE. TYPE VARIES.
- 0100 INUNDATION AREA

**JUMIRUM CREEK DATA**

**CROSSING No. 1**  
 CATCHMENT AREA: 142ha DEVELOPED  
 235 ha UNDEVELOPED  
 0100 T.W. @ 0100: 97.30 Cumecs  
 349.00m  
 OUTLET VELOCITY 0100 3.27m/sec  
 CULVERT: SUPER-COR BOX SC-508 OR EQUIVALENT

**CROSSING No. 2**  
 CATCHMENT AREA: 130ha DEVELOPED  
 201 ha UNDEVELOPED  
 0100 T.W. @ 0100: 92.60 Cumecs  
 351.93m  
 OUTLET VELOCITY 0100 3.50m/sec  
 CULVERT: SUPER-COR BOX SC-508 OR EQUIVALENT

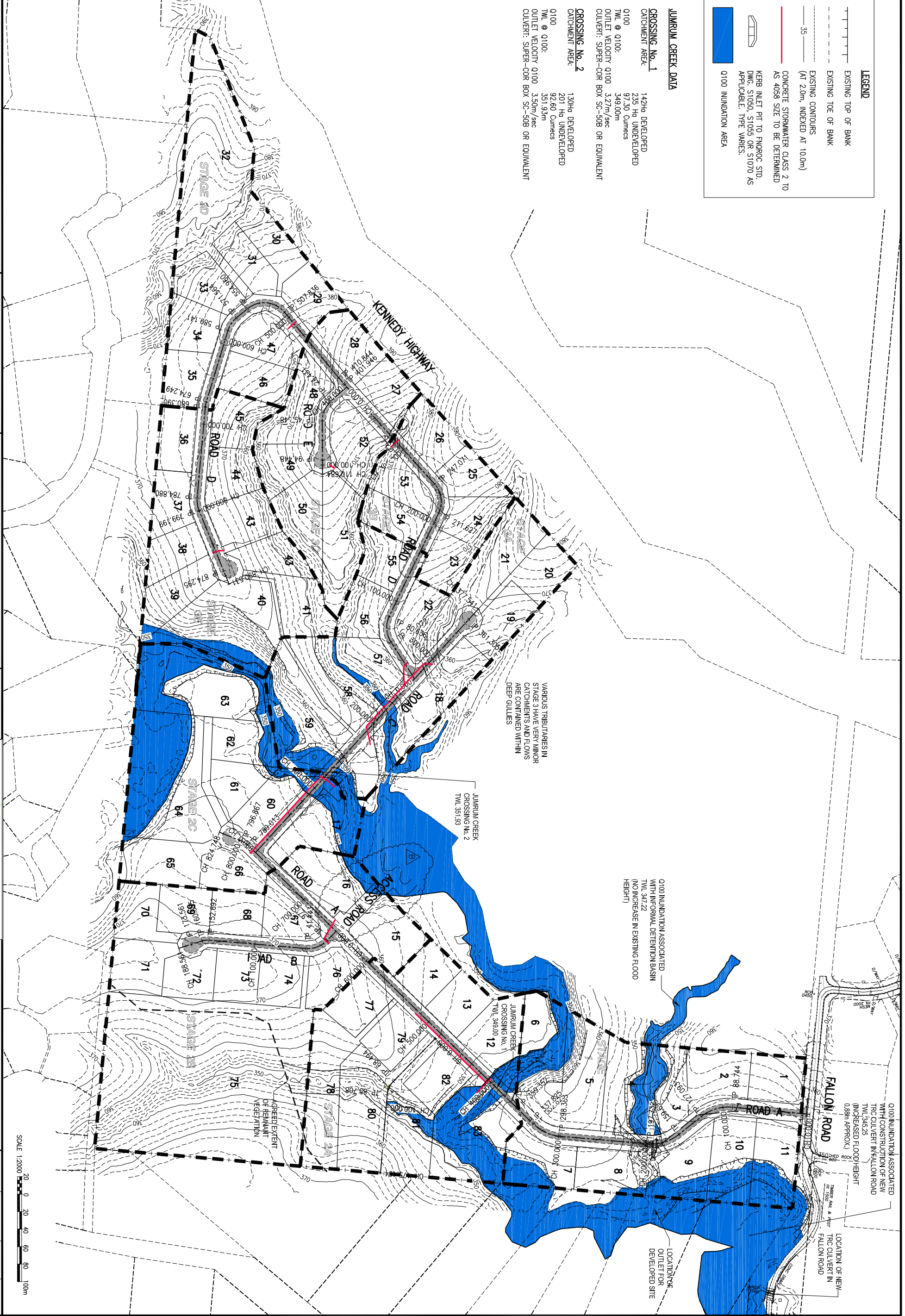

SCALE 1:2000  
 0 20 40 60 80 100m

amendments	
A	ORIGINAL ISSUE
B	LOT LAYOUT ALTERED
	30.05.12
	29.01.13

**JIM PAPAS DRAFTING**  
**PTY. LTD.**  
 CIVIL ENGINEERING DESIGN AND DRAFTING  
 P. O. Box 2347  
 Mareeba Q 4880  
 Email: jim.papas@westnet.com.au  
 Ph. (07) 4092 4638  
 Mob. 0408 770 394



**PROPOSED RURAL RESIDENTIAL DEVELOPMENT AT FALLON ROAD, KURANDA**

DRAWING TITLE: PROPOSED ROAD LAYOUT AND STORMWATER DRAINAGE	
SCALE (AT A1 SIZE)	HOR 1:2000
DATE	AUGUST 2012
APPROVED	
DWG NUMBER	1180 SK14-36
AUDT	B